



SWITCHGEAR

RENEWAL PARTS ORDERING GUIDE

**TYPES MA-75C1, MA-250C1, and MA-350C1 5KV
AIR MAGNETIC CIRCUIT BREAKERS
WITH 515-1 STORED
ENERGY OPERATORS**

Supplement to 18X5165

18X5166

July, 1974

USAGE CODE TABLE

Type	Application	Operator	Top Level Assembly	Usage Code*
MA-75C1	1200 AMP	Stored Energy	72-422-904-601	◆ A
MA-250C1	1200 AMP	Stored Energy	72-422-904-604	B -
MA-250C1	1200 AMP (80KA)	Stored Energy	72-422-904-605	C
MA-250C1	1200/2000 AMP	Stored Energy	72-422-904-606	D
MA-250C1	2000 AMP	Stored Energy	72-422-904-608	E
MA-250C1	2000 AMP (80KA)	Stored Energy	72-422-904-609	F
			72-422-907-601	G
MA-350C1	1200 AMP	Stored Energy	72-422-906-601	H
MA-350C1	2000 AMP	Stored Energy	72-422-906-602	I

*If no usage code appears in the "USAGE" column of the following parts lists, the part is used on all assemblies listed in the figure title.

ITEM	DESCRIPTION	PART NUMBER	USAGE	ITEM	DESCRIPTION	PART NUMBER	USAGE
01	MA-75-150 1200 Amp	71-401-833-501	A	18	Spacer	71-107-716-010	
	MA-250 1200 Amp	71-401-833-502	B	19	Rod	71-107-724-001	
	MA-250 1200 Amp	71-401-833-508	C	20	Washer	71-916-992-002	
	80 KA			21	Not Used		
	MA-250 1200/2000 Amp	71-401-833-511	D	22	Plate	71-112-911-001	
	MA-250 2000 Amp	71-401-833-504	E	23	Spacer	71-112-948-001	
	MA-250 2000 Amp	71-401-833-509	F	24	Barrier	71-112-971-001	
	80 KA			25	Bar	71-113-038-001	
+✓ 1	Contact Assembly 3	71-112-966-502	BCDEF	26	Spacer	71-113-101-001	A
		71-112-966-501	A	27	Strip	71-113-681-001	
+ 2	Contact Assembly 3	71-112-913-502	BCDEFHI	28	Strip	71-114-147-001	
		71-112-913-501	A	29	Insulation	71-114-148-001	
+ 3	Contact Assembly 3	71-112-913-503	BCDEFHI	30	Support	71-114-547-001	
+ 4	Top Stud Ass'y.	71-208-214-506	EFI	31	Washer	71-152-809-030	
		71-208-214-509	CGH	32	Washer	71-158-647-015	
		71-208-214-505	B	33	Belville Washer	71-140-901-001	
		71-208-214-510	D	34	Washer	71-167-537-001	
		71-208-214-504	A	35	Tubing	71-172-682-010	
5	Lower Stud Ass'y.	71-209-087-501	EFI	36	Washer	71-177-196-003	
		71-208-831-501	ABCGH	+ 37	Spring	72-120-400-001	W
		71-209-087-502	D	38	Channel Assembly	18-657-377-501	
6	Disc Arm Ass'y.	71-208-255-511	CDEFI	39	Roll Pin	00-671-176-350	
		71-208-255-507	A	40	Screw	00-615-114-432	A
		71-208-255-509	B	41	Screw	00-615-114-438	BC
		71-208-255-515	ABC	42	Screw	00-615-114-440	DEF
7	Disc Arm Ass'y.	71-208-255-512	DEFI	43	Nut	15-171-063-006	
		71-208-255-508	A	44	Screw	00-615-249-235	BC
		71-208-255-510	B	45	Washer	00-655-017-022	
		71-208-255-516	ABC	46	Screw	00-615-249-239	DEF
8A	Contact Finger Ass'y.	18-657-372-501		47	Screw	00-615-261-231	A
8B	Contact Finger Ass'y.	18-657-372-505		48	Cotter Pin	00-671-195-119	A
9	Tube	71-115-598-001	CDFI	49	Pin	00-957-211-902	A
		71-107-672-001	ABC	50	Screw	00-611-315-373	
10	Tube	71-115-598-002	DE	51	Screw	15-611-318-428	
		71-107-672-010	AB	52	Screw	00-611-315-461	
11	Spacer	71-107-716-001		53	Screw	15-611-318-556	
12	Tubing	72-120-735-003	DEF	54	Screw	00-611-318-558	
		72-120-735-001	A	55	Screw	00-615-615-218	
		72-120-735-002	BH	56	Screw	00-611-375-227	
13	Plate	71-112-910-001		57	Nut	15-171-063-006	
14	Yoke	71-112-934-001	A	58	Nut	15-171-063-065	
		18-657-777-565	BCDEF	59	Nut	15-171-063-008	
15	Washer	71-177-196-005	A	60	Pin	00-671-176-350	
		71-114-701-001	BCDEF	61	Washer	00-651-007-900	
16	Tube	71-170-947-008	DEF	62	Washer	00-651-017-087	
		71-170-947-007	ABC	63	Washer	00-655-017-022	
17	Bracket	71-302-850-002	DEF	64	Washer	00-655-017-026	
		71-302-850-001	ABC	65	Washer	00-651-017-913	
		71-302-850-003	GH				
		71-302-850-005	I				

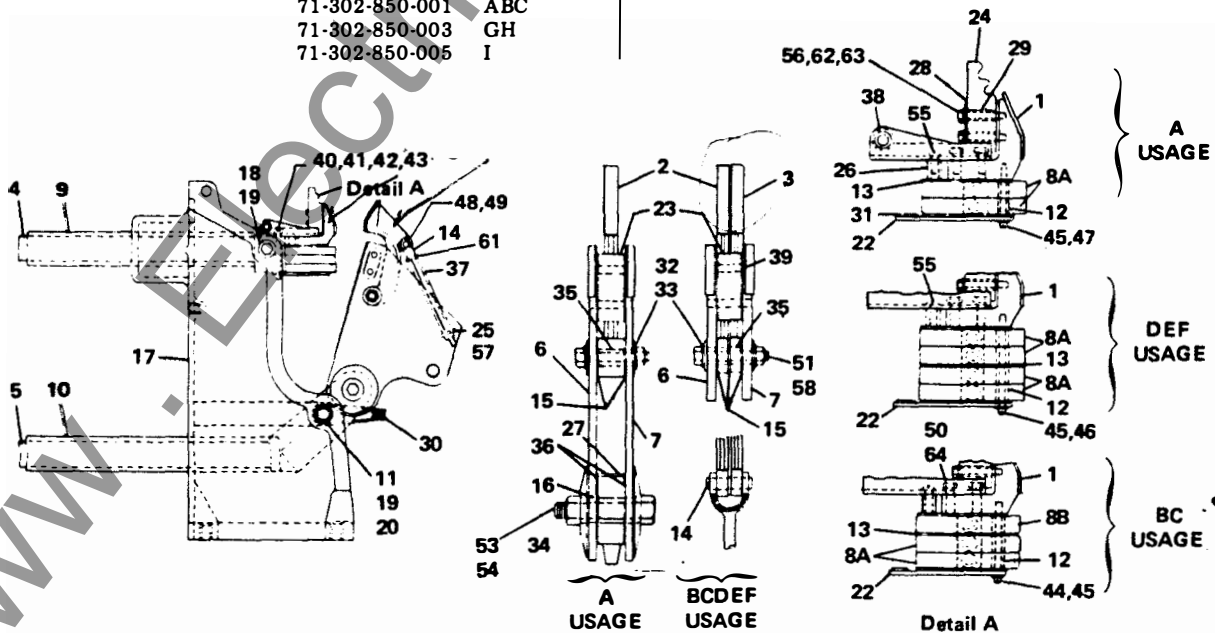

Figure 2. Stud and Support Assembly — Codes A through F (See Code Table, page ii)

ITEM DESCRIPTION FOR FIGURE 4.

ITEM	DESCRIPTION	PART NUMBER	USAGE	ITEM	DESCRIPTION	PART NUMBER	USAGE
1	Frame & Operator Assembly	18-468-553-502	CDEF	46	Nut	00-631-003-204	
		18-468-553-501	ABDE	47	Cotter Pin	00-671-195-049	
2	Operator Assembly	18-657-514-597		48	Screw	00-617-499-421	
3	Pad	71-116-231-002	HI	49	Yoke	00-615-114-542	
4	Washer	71-163-273-002	HI	50	Yoke	00-691-701-903	
5	Guide Assembly	71-208-910-501		51	Crank Assembly	18-724-395-501	
6	Piston Assembly	71-114-161-503		52	Ball Joint	00-833-573-003	
7	Guide Assembly	71-114-765-501		53	Clevis Pin	00-957-211-910	
8	Grounding Contacts	71-114-787-502		54	Ratchet Plate	00-633-182-060	
9	Bracket Assembly	71-116-800-501		54A	Nut	15-171-063-006	
10	Bracket Assembly	71-116-800-502		55	Aux. Switch	71-208-922-505	
11	Clamp	15-171-070-002		56	Channel	72-120-062-001	
12	Foot Pedal Assembly (Includes items 63 & 69)	72-120-586-501		57	Pin	15-676-386-002	
13	Pin	71-104-754-034		58	Plate	71-208-856-501	
14	Rod	72-120-688-001		59	Clamp	00-857-271-105	
15	Plunger	71-113-442-001		60	Cement	00-331-121-063	
16	Yoke End	71-113-487-001		61	Clamp	15-171-070-001	
17	Rod End	71-113-541-001		62	Spring	71-113-502-001	
18	Spring	71-113-621-001		63	Switch	00-871-351-107	
19	Cup	71-114-151-002		64	Cover	72-120-228-001	
20	Compression Spring	71-114-153-001		65	Shim	71-108-654-006	
21	Bumper	71-114-154-001		66	Screw	00-615-114-384	
22	Cylinder	71-114-155-003		67	Washer	71-152-809-012	
23	Packing	71-114-156-001		68	Nut	15-171-063-004	
24	Spring	71-114-733-001		69	Bracket	72-220-073-001	
25	Stop	71-114-749-002		70	Crank Assembly	18-724-395-501	
26	Link	71-114-752-001		71	Nut	00-631-003-204	
27	Tube	71-114-860-002		72	Nut	00-633-025-216	
28	Bracket	71-114-786-001		73	Spring	71-204-604-028	
29	Block Assembly	18-657-410-599		74	Pull Rod	18-657-522-262	
30	Valve Disc	71-115-244-001		75	Nut	00-855-759-104	
31	Guard	71-118-452-001		76	Flex Shaft Support	18-652-523-335	
32	Compression Spring	71-140-125-001		77	Sec. Disconnect Ass'y.	72-120-287-501	
33	Pin	71-915-161-032		78	Washer	71-152-908-002	
34	Pin	71-919-736-009		79	Roll Pin	00-671-176-189	
35	Rivet	00-671-501-030		80	Roller	72-120-706-001	
36	Indicator	72-120-190-001		81	Bolt	00-611-343-030	
37	Bracket	18-657-491-589		82	Nut	00-633-025-220	
38	Roll Pin	00-671-176-377		83	Bracket	18-723-506-001	
39	Rod	72-120-594-001		84	Crank Assembly	18-723-507-501	
40	Wheel	15-171-067-002		85	Pin	00-957-211-901	
41	Eye End	00-691-713-102		86	Pin	00-671-195-119	
42	Bar	72-120-689-001		87	Yoke End Adj.	00-691-701-901	
43	Washer	71-152-809-002		88	Nut	00-631-003-204	
44	Pin	72-120-578-001		89	Pin	00-957-221-010	
45	Lever Assembly	72-120-568-500		90	Pin	00-671-195-119	
				91	Link	18-657-767-327	
				92	Pin	15-171-181-002	

ITEM DESCRIPTION FOR FIGURE 5.

ITEM	DESCRIPTION	PART NUMBER	USAGE	ITEM	DESCRIPTION	PART NUMBER	USAGE
1	Frame Assembly	18-469-102-501		69	Screw	00-615-245-222	
2	Needle Bearing	00-813-119-810		70	Lockwasher	00-655-017-022	
3	Needle Bearing	00-813-119-814		71	Screw	00-615-245-218	
4	Needle Bearing	00-813-119-821		72	Term. Block Supp.	18-657-524-111	
5	Pawl Assembly	18-657-485-536			Bracket		
6	Stop Bracket Ass'y.	18-657-513-576		73	Term. Block	00-857-036-012	
7	Shaft	18-657-467-291		74	Screw	00-615-471-124	
8	Slit Spacer	18-657-800-113		75	Lockwasher	00-655-047-060	
9	Collar	18-657-467-290		80	Chain Link	00-831-349-065	
10	Inner Race**	18-657-467-335		81	Pin	18-657-464-105	
11	Spacer	18-158-935-009		82	Retaining Ring	00-673-165-075	
12	Thrust Washer	00-815-225-131		83	Washer	71-152-809-026	
13	Needle Bearing	15-813-119-003		84	Radius Arm	18-390-227-501	
14	Pin	18-657-463-368		85	Stop	18-657-464-118	
15	Stop Latch	18-657-463-388		86	Washer	00-655-067-200	
16	Trip Latch	18-657-463-390		87	Check Switch Brkt.	18-657-782-273	
17	Pin	18-657-464-012		88	Grease	00-337-131-001	
18	Pin	18-657-523-064		89	Grommet	00-691-872-130	
19	Shaft	18-657-463-389		90	Spring Retainer	18-657-523-038	
20	Motor*	18-469-223		91	Shaft	18-657-463-369	
21	Charge Disc. Actuator	18-657-522-305		92	Drive Block	18-657-465-170	
22	Bracket	18-657-522-304		93	Bearing Block	18-657-463-370	
23	Interlock Rod	18-657-522-269		94	Spring	15-171-331-001	
24	Roller Bearing	15-813-073-003		95	Spring	15-171-331-003	
25	Torsion Spring	18-657-466-081		96	Retaining Ring	00-673-165-100	
26	Torsion Spring	18-657-466-080		97	Retaining Ring	00-673-165-087	
27	Pawl Return Spring	18-657-229-240		98	Shim	18-657-784-007	
28	Conical Spring	18-657-522-242		99	Screw	00-615-114-556	
29	Retaining Ring	00-673-165-062		100	Flex. Shaft Assembly	18-657-768-377	
30	Spacer	18-158-935-011		101	Roll Pin	00-671-176-185	
31	Adj. Screw	00-617-499-375		102	Clamp	15-171-386-002	
32	Roll Pin	00-671-176-224		103	Washer	71-114-297-001	
33	Roll Pin	00-671-176-325		104	Link	71-118-760-001	
34	Roll Pin	00-671-176-383		105	Link	18-657-464-103	
35	Roll Pin	15-671-173-002		106	Roller	15-813-073-001	
36	Roll Pin	00-671-171-375		107	Pin	18-657-464-104	
37	Washer	18-657-522-303		108	Spring	18-657-523-331	
38	Washer	71-152-809-024		109	Washer	71-152-809-026	
39	Screw	00-615-245-218		110	Spring Holder	18-657-523-332	
40	Lockwasher	00-655-017-022		111	Retaining Ring	00-673-165-075	
41	Screw	00-611-315-392		112	Spring Anchor	18-657-523-333	
42	Washer	00-651-007-160		113	Link	18-657-800-115	
43	Lockwasher	00-655-017-026		114	Needle Bearing	00-813-119-813	
44	Elastic Stop Nut	00-633-025-116		115	Plate	18-723-641-001	
45	Jam Nut	00-631-143-104		116	Terminal Block	00-857-036-012	
46	Roll Pin	00-671-176-373		117	Microswitch*	15-171-323-001	
47	Roll Pin	00-671-171-379		118	Microswitch*	15-171-323-002	
48	Spacer	18-657-523-278		119	Actuator Arm	18-657-522-355	
49	Flex Shaft Support	18-657-523-335		120	Shield	18-657-468-090	
50	Roll Pin	00-671-176-189		121	Extension Spring	18-657-523-061	
51	Ratchet Assembly	18-390-202-501		122	Screw	00-615-471-130	
52	Cam Assembly	18-389-061-501		123	Washer	00-655-047-060	
53	Cam Assembly	18-389-061-502		124	Nut	14-147-052-002	
54	Linkage Assembly (Consists of items 104 to 113)			125	Screw	00-617-247-468	
55	Motor & Closing Control	18-390-246-501		126	Nut	00-631-171-106	
56	Indicator Assembly	18-723-511-501		127	Washer	00-655-017-032	
57	Bracket Assembly	18-657-491-589		128	Washer	00-651-007-230	
58	Pin	18-724-690-003		129	Screw	00-615-471-124	
59				130	Screw	00-615-485-216	
60	Solenoid Trip Link Assembly	18-657-770-518		131	Washer	00-655-017-022	
61	Switch Bracket	15-171-367-001		132	Washer	00-651-007-907	
62	Roll Pin	00-671-176-309		133	Relay	00-871-797-107	
63	Solenoid*	15-171-339				00-871-797-108	
64	Solenoid*	15-171-339				00-871-797-109	
65	Trip Latch Switch*	15-171-323-				00-871-797-115	
66	Strip	18-657-467-239		134	Washer	00-655-047-080	
67	Screw	00-615-223-172		135	Screw	00-615-223-174	
68	Lockwasher	00-655-017-020		136	Relay	25-134-022-501	
						25-134-022-502	

*Give breaker S/N and control voltage when ordering item.

**Must be supplied in pairs.

***Must be supplied as matched set.

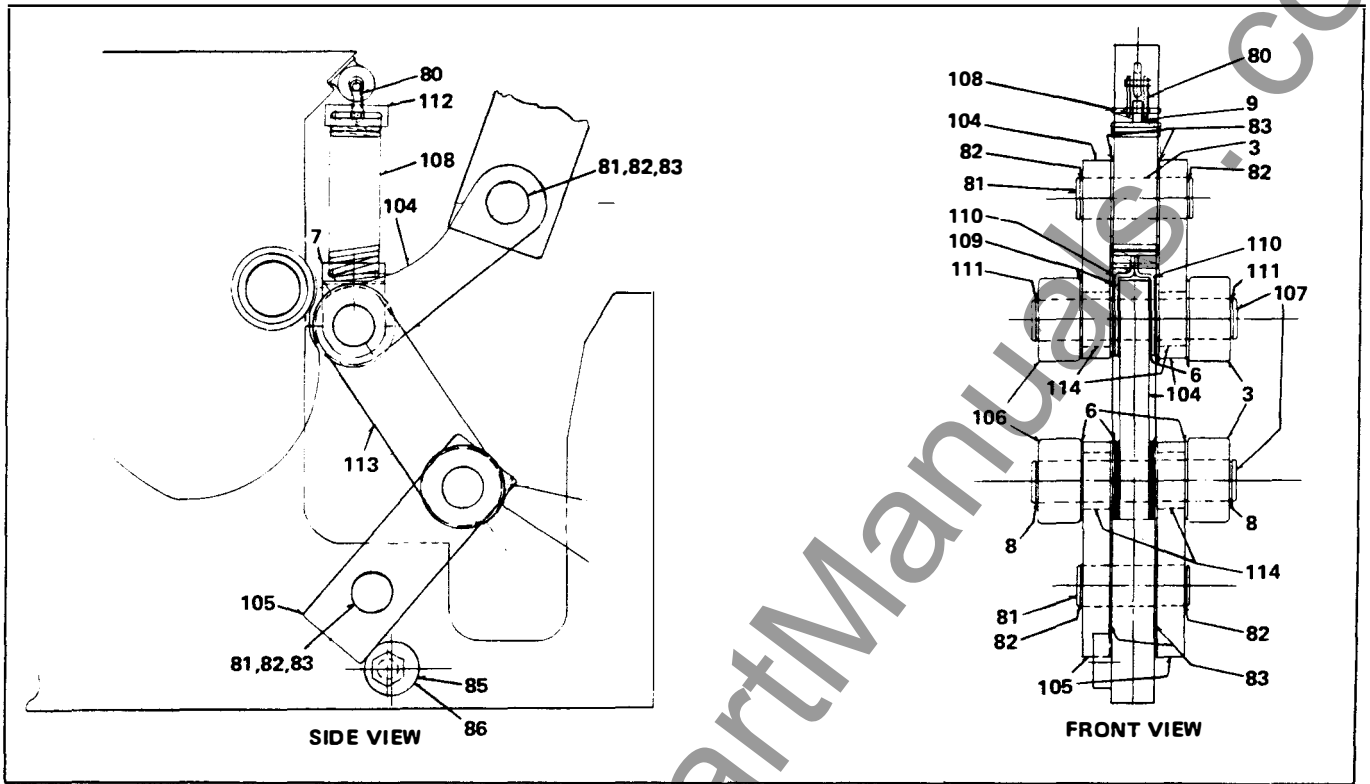

VIEW B

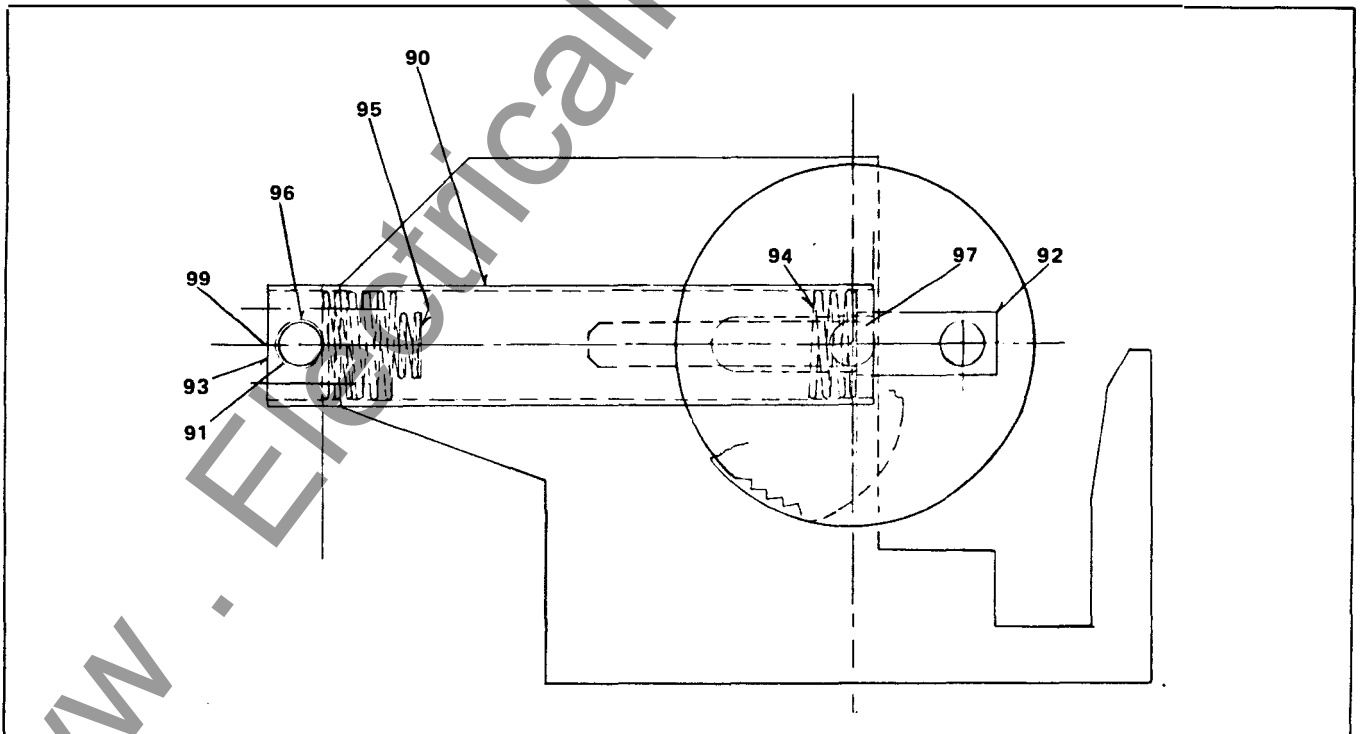

VIEW C

ITEM	DESCRIPTION	PART NUMBER	USAGE	ITEM	DESCRIPTION	PART NUMBER	USAGE
1	Contact Finger Ass'y.	18-657-456-579	I	17	Indicator - Closed	71-114-830-001	
2	Contact Finger Ass'y.	18-723-565-501	H	18	Indicator - Open	71-114-830-002	
3	Barrier Assembly	71-118-797-502		19	Arrow	71-117-508-001	
3a	Angle	72-120-128-002		20	Indicator	71-167-932-001	
3b	Barrier	71-210-600-003		21	Counter	71-110-940-001	
3c	Guide	71-116-354-001		22	Spring	71-114-806-001	
3d	Washer	71-114-297-003		23	Shield	72-320-079-001	
3e	Rivet	00-671-501-070		24	Handle	71-207-184-001	
3f	Rivet	00-671-501-040		25	Nut	15-171-033-002	
3g	Angle	71-120-128-003		26	Frame & Operator (See Figure 4)	72-420-070-502	
4	Label	71-113-871-001		27	Shim	71-109-843-001	
5	Phase Barrier Ass'y.	71-114-505-503		28	Shim	71-109-843-002	
5a	Zee Plate	71-208-834-001		29	Shim	71-109-843-003	
5b	Barrier	71-116-182-002		30	Link	71-113-440-003	
5c	Guide	71-116-468-002		31	Tube	71-114-548-001	
5d	Rivet	00-671-501-030		32	Shim	71-114-833-001	
6	Phase Barrier Ass'y. (See item 5)	71-114-505-504		33	Angle	71-114-834-001	
7	Phase Barrier Ass'y.	71-116-181-501		34	Pin	71-164-062-012	
7a	Barrier	71-116-182-001		35	Tube	71-114-860-001	
7b	Channel	71-116-217-001		36	Stud & Support (See Figure 2)	71-401-833-505	
7c	Channel	71-209-353-001		37	Arc Chute Ass'y. (01) (See Figure 7) (01 & 3)	71-401-838-501	
7d	Channel	71-209-353-002		38	Clevis	00-957-212-007	
7e	Rivet	00-671-501-030		39	Bumper	00-837-695-008	
8	Panel Spring Ass'y.	72-120-043-501		40	Screw	00-611-315-375	
9	Barrier	71-208-845-001		41	Nut	15-171-063-004	
10	Barrier	71-208-845-002		42	Washer	00-651-007-160	
11	Panel	71-208-897-001		43	Screw	00-611-315-382	
12	Connector	71-114-708-001		44	Label	71-114-294-001	
13	Strap	71-115-588-002		45	Label	15-171-083-030	
14	Indicator	71-111-259-001		46	Screw	00-617-475-375	
15	Indicator	71-111-260-001					
16	Label	71-114-320-001					

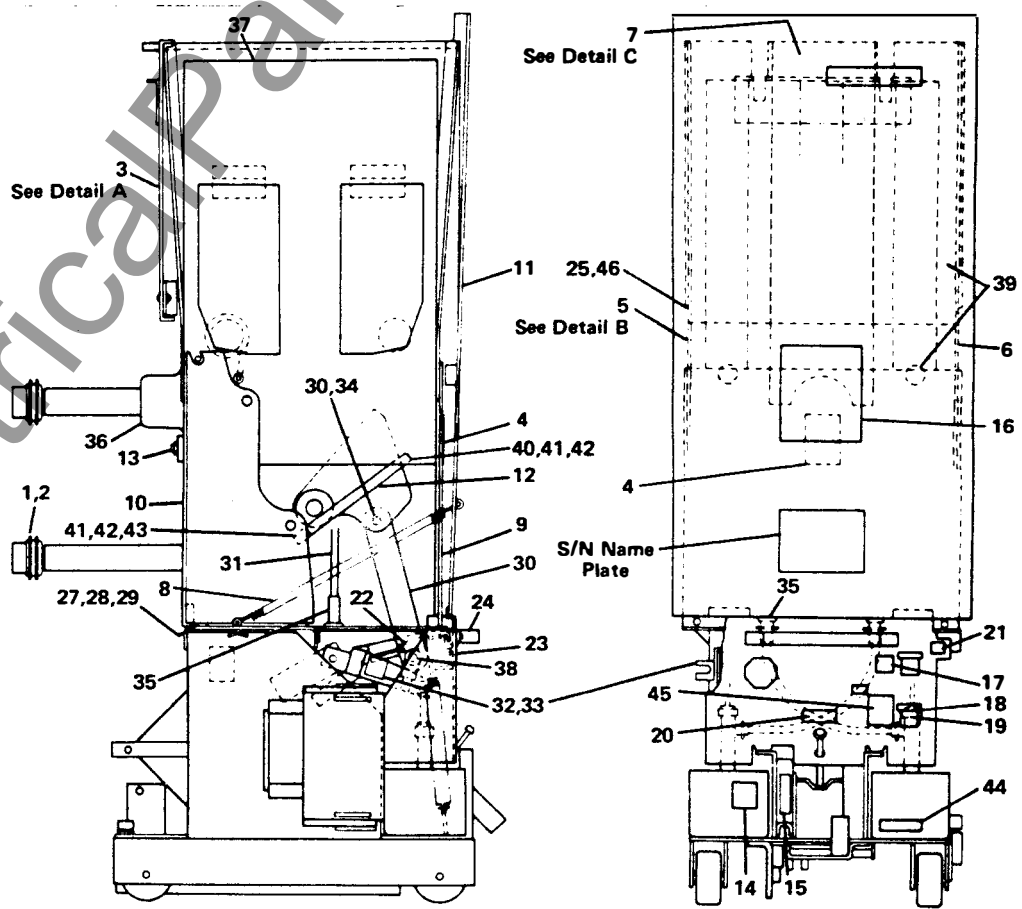
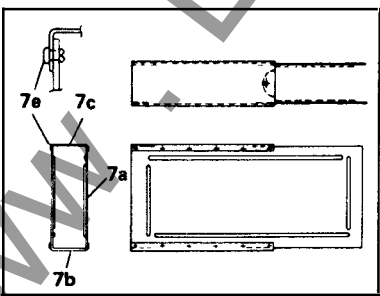
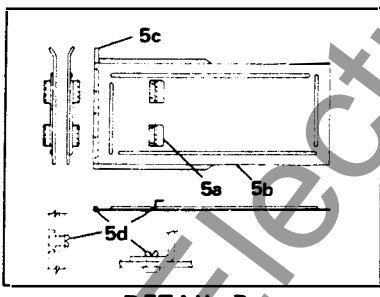
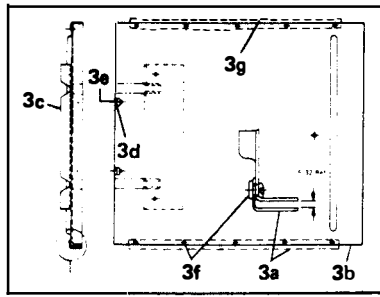

Figure 6. Type MA-350C1 Stored Energy Operated Breaker Assembly
1200 AMP (Code H) and 2000 AMP (Code 1) (See Code Table, page ii)

ITEM	DESCRIPTION	PART NUMBER	USAGE	ITEM	DESCRIPTION	PART NUMBER	USAGE
01	Stud & Support Ass'y.	71-401-833-505	H	17	Bracket	71-302-850-002	
02	Stud & Support Ass'y.	71-401-833-507	I			71-302-850-001	
1	Contact Assembly	71-112-966-502				71-302-850-003	H
2	Contact Assembly	71-112-913-502				71-302-850-005	I
3	Contact Assembly	71-112-913-503		18	Spacer	71-107-716-010	
4	Top Stud Ass'y.	71-208-214-506	I	19	Rod	71-107-724-001	
		71-208-214-509	H	20	Washer	71-916-992-002	
5	Lower Stud Ass'y.	71-209-087-501		21	Screw	00-615-114-438	
		71-208-831-501		22	Plate	71-112-911-001	
6	Disc Arm Ass'y.	71-208-255-511	I	23	Spacer	71-112-948-001	
		71-208-255-515	H	24	Barrier	71-112-971-001	
7	Disc Arm Ass'y.	71-208-255-512	I	25	Bar	71-113-038-001	
8	Contact Finger Ass'y.	18-657-372-501		26	Screw	00-615-249-235	
9	Tube	71-115-598-001	I	27	Strip	71-113-681-001	
		71-107-672-001	H	28	Strip	71-114-147-001	
10	Tube	71-115-598-002	I	29	Insulation	71-114-148-001	
		71-107-672-010	H	30	Support	71-114-547-001	
11	Spacer	71-107-716-001		31	Washer	71-152-809-030	
12	Tubing	72-120-735-003		32	Washer	71-158-647-015	
13	Plate	71-112-910-001		33	Belville Washer	71-140-901-001	
14	Yoke	18-657-777-565		34	Washer	71-167-537-001	
		71-114-697-001		35	Tubing	71-172-682-010	
15	Washer	71-177-196-005		36	Washer	71-177-196-003	
		71-114-701-001		37	Spring	72-120-400-001	
16	Tube	71-170-947-007		38	Channel Assembly	18-657-377-501	
				39	Roll Pin	00-671-176-350	

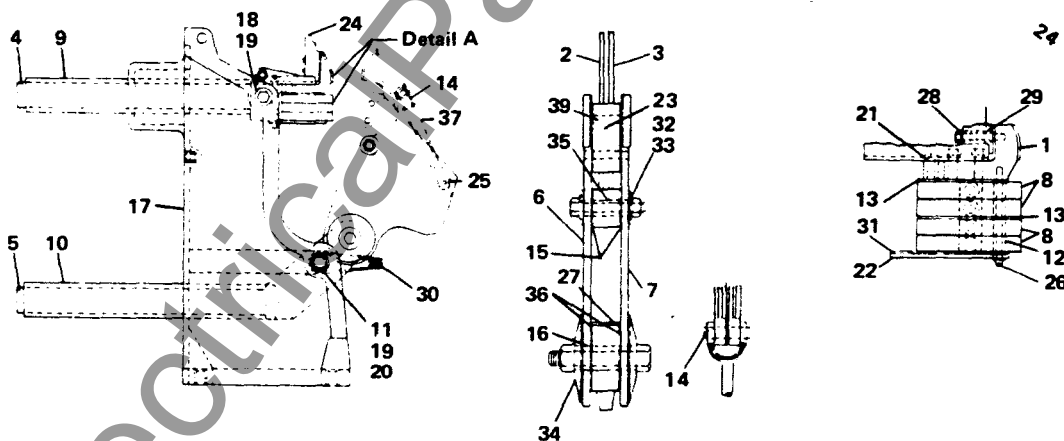

Figure 8. Type MA-350C1 Stud and Support Assembly – Codes H & I (See Code Table, page ii)

CORRECTION SHEET

This sheet(s) notes changes which should be made in the attached instruction booklet:

ITEM	DESCRIPTION	PART NUMBER
1	PHASE BARRIER - CTR	71-208-033-501
2	PHASE BARRIER - LH	71-114-505-501
3	PHASE BARRIER - RH	71-114-505-502
4	FRONT BARRIER	71-208-845-001
5	REAR BARRIER - LOWER	71-208-845-002
6	REAR BARRIER - UPPER	71-118-797-501
7	SCREW (PLASTIC)	00-617-475-375
8	NUT	15-171-033-002
9	SUPPORT	72-120-203-001
10	SUPPORT	71-210-601-002
11	HEX HD CAP SCR .25x3.75 LG	00-611-315-397
12	STOVER LOCKNUT - 25	15-171-063-004
13	ROUNDWASHER - 25	00-651-007-146
14	HEX HD CAP SCR .31x4.62 LG	00-611-315-417
15	ROUNDWASHER - 31	00-655-017-300
16	LOCKWASHER - 31	00-655-017-030
17	HEX HD CAP SCR .31x7.5 LG	00-611-315-419
18	HEX HD CAP SCR .31x4.75 LG	15-611-318-419

ITEM	DESCRIPTION	PART NUMBER
1	PHASE BARRIER - LH-CYR-RH	71-118-091-003
2		
3		
4	FRONT BARRIER	18-723-584-502
5	REAR BARRIER	18-723-584-503
6		
7		
8		
9		
10	SUPPORT	71-201-601-002
11	HEX HD CAP SCR .25x3.75 LG	00-611-315-397
12	STOVER LOCKNUT - 25	15-171-063-004
13	ROUNDWASHER - 25	00-651-007-146
14	HEX HD CAP SCR .31x4.62 LG	00-611-315-417
15	ROUNDWASHER - 31	00-651-007-300
16	LOCKWASHER - 31	00-655-017-030
17		
18	HEX HD CAP SCR .31x4.75 LG	15-611-318-419

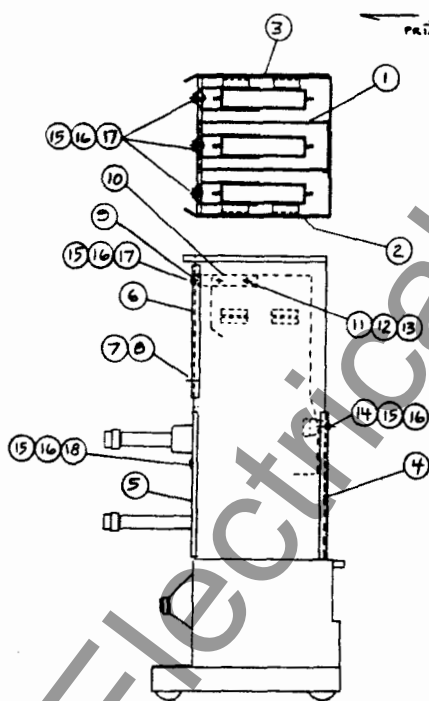

MA-75 MA-250

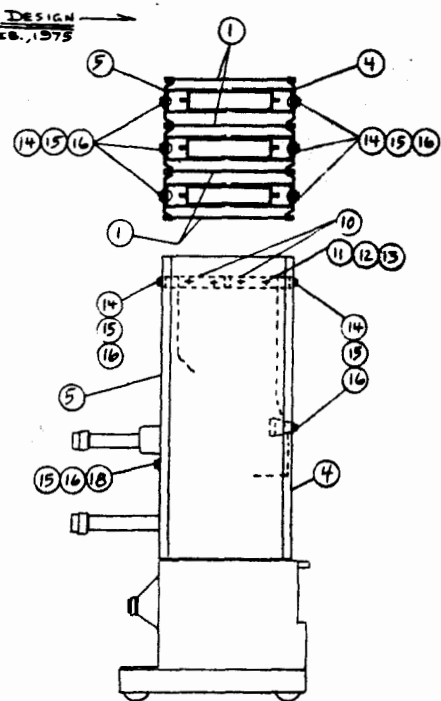

MA-75 MA-250

These instructions do not purport to cover all details or variations in equipment nor to provide for every possible contingency to be met in connection with installation, operation or maintenance.



CORRECTION SHEET

This sheet(s) notes changes which should be made in the attached instruction booklet:

ITEM	DESCRIPTION	PART NUMBER
1	PHASE BARRIER - CTR	71-208-033-501
2	PHASE BARRIER - LH	71-114-505-501
3	PHASE BARRIER - RH	71-114-505-502
4	FRONT BARRIER	71-208-845-001
5	REAR BARRIER - LOWER	71-208-845-002
6	REAR BARRIER - UPPER	71-118-797-501
7	SCREW (PLASTIC)	00-617-475-375
8	NUT	15-171-033-002
9	SUPPORT	72-120-203-001
10	SUPPORT	71-210-601-002
11	HEX HD CAP SCR .25x.375 L6	00-611-315-397
12	STOVER LOCKNUT - 25	15-171-063-004
13	ROUNDWASHER - 25	00-651-007-146
14	HEX HD CAP SCR .31x.62 L6	00-611-315-417
15	ROUNDWASHER - 31	00-651-007-500
16	LOCKWASHER - 31	00-655-017-030
17	HEX HD CAP SCR .31x.75 L6	00-611-315-419
18	HEX HD CAP SCR .31x.75 L6	15-611-318-419

ITEM	DESCRIPTION	PART NUMBER
1	PHASE BARRIER - CTR - CTR - CTR	71-118-031-003
2		
3		
4	FRONT BARRIER	18-723-584-502
5	REAR BARRIER	18-723-584-503
6		
7		
8		
9		
10	SUPPORT	71-201-601-002
11	HEX HD CAP SCR .25x.375 L6	00-611-315-397
12	STOVER LOCKNUT - 25	15-171-063-004
13	ROUNDWASHER - 25	00-651-007-146
14	HEX HD CAP SCR .31x.62 L6	00-611-315-417
15	ROUNDWASHER - 31	00-651-007-500
16	LOCKWASHER - 31	00-655-017-030
17		
18	HEX HD CAP SCR .31x.75 L6	15-611-318-419

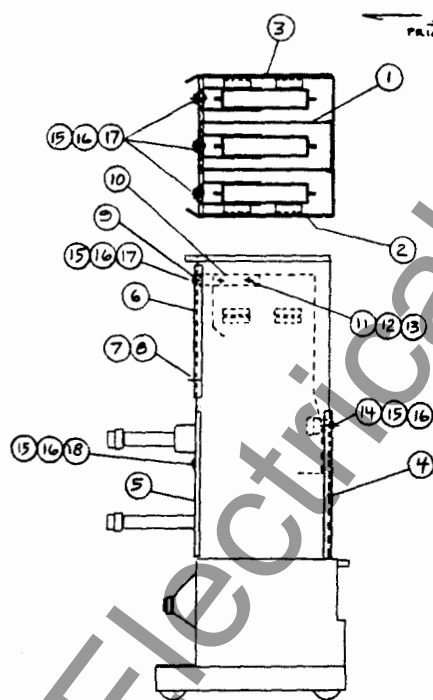

MA-75 MA-250

OLD DESIGN PRIOR TO FEB., 1975 NEW DESIGN EFF FEB., 1975

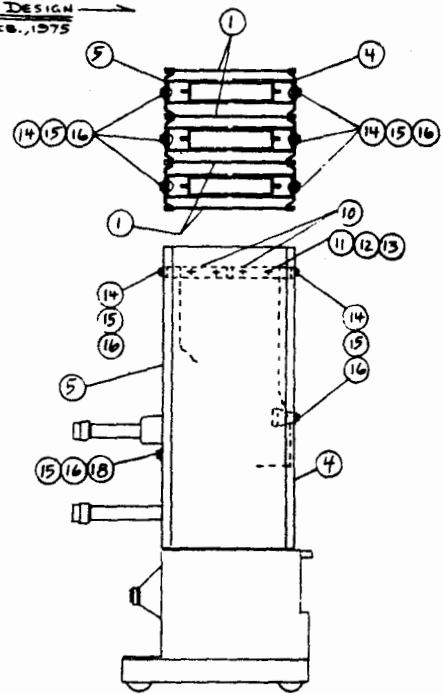

MA-75 MA-250

These instructions do not purport to cover all details or variations in equipment nor to provide for every possible contingency to be met in connection with installation, operation or maintenance.



CORRECTION SHEET

This sheet(s) notes changes which should be made in the attached instruction booklet:

ITEM	DESCRIPTION	PART NUMBER
1	PHASE BARRIER - CTR.	71-116-181-001
2	PHASE BARRIER - LH.	71-114-205-003
3	PHASE BARRIER - RH.	71-114-205-004
4	FRONT BARRIER	71-200-045-001
5	REAR BARRIER - LOWER	71-200-045-002
6	REAR BARRIER - UPPER	71-116-737-002
7	STRAP	71-115-588-002
8	BLOCK	71-116-188-001
9	SEC. HD. CAP SCR. - 3/4x1.25 L6	00-615-124-424
10	ROUNDWASHER - .31	00-651-007-300
11	LOCKWASHER - .31	00-653-017-030
12	HEX HD. CAP SCR. - 3/4x.62 L6	00-611-315-417
13	HEX HD. CAP SCR. - 3/4x.75 L6	00-611-315-413

ITEM	DESCRIPTION	PART NUMBER
1	PHASE BARRIER - LH-CYR-R.H.	71-116-031-003
2		
3		
4	FRONT BARRIER	18-723-530-004
5	REAR BARRIER	18-723-530-005
6		
7	STRAP	71-115-588-002
8	BLOCK	71-116-188-001
9	SEC. HD. CAP SCR. - 3/4x1.25 L6	00-615-124-424
10	ROUNDWASHER - .31	00-651-007-300
11	LOCKWASHER - .31	00-653-017-030
12	HEX HD. CAP SCR. - 3/4x.62 L6	00-611-315-417
13		

OLD DESIGN
PRIOR TO FEB., 1975

NEW DESIGN
EFFECTIVE FEB., 1975

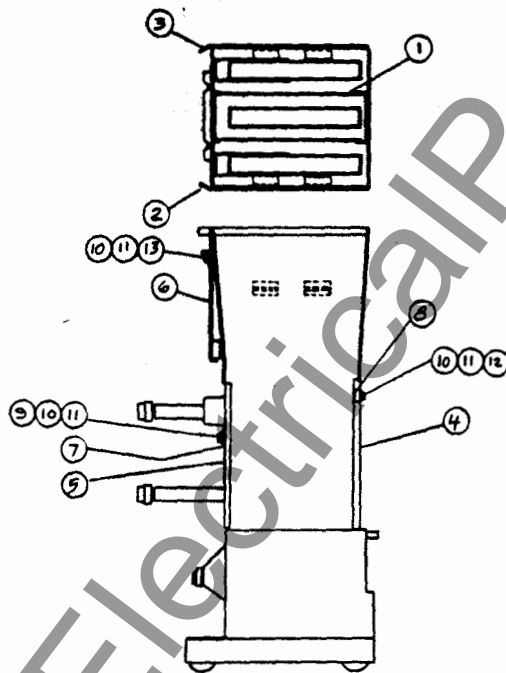

MA-350

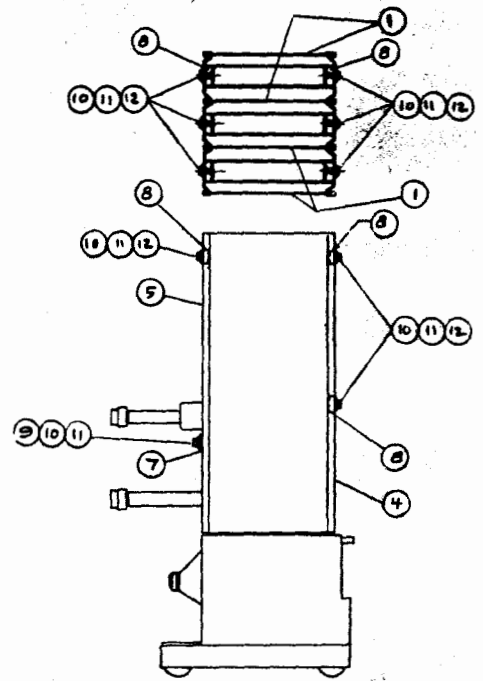

MA-350

These instructions do not purport to cover all details or variations in equipment nor to provide for every possible contingency to be met in connection with installation, operation or maintenance.



SWITCHGEAR
DIVISION

www.ElectricalPartManuals.com